

STAMP 31836 M39012/23-0001
KC-79-110 XXXX

DATE CODE

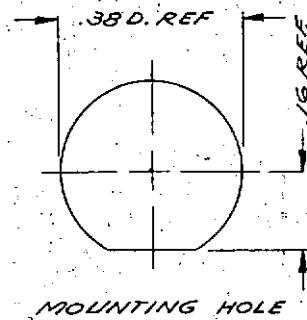
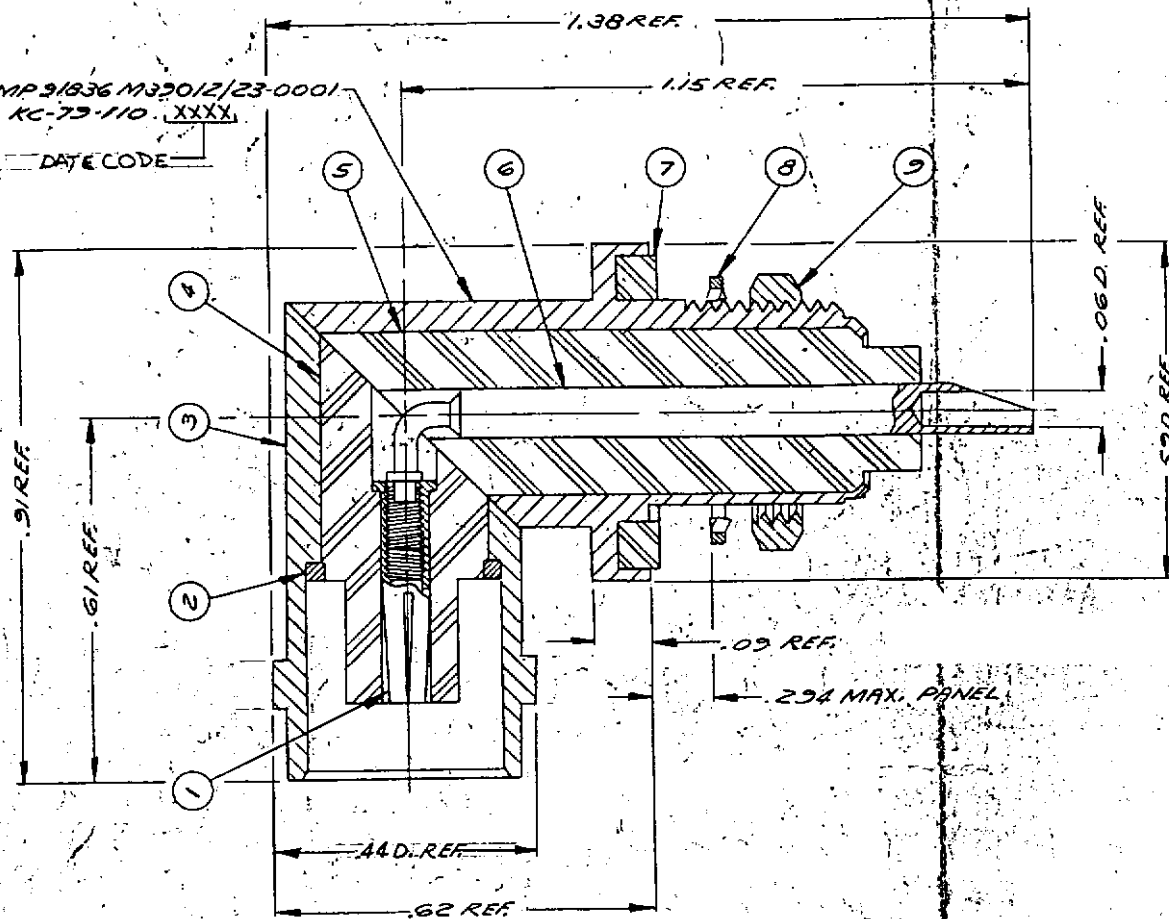

| REVISIONS | |
|-----------|-----------------------------|
| ISSUE | CHANGES |
| 0 | ER 10589 CC 8 DEC 71 |
| 1 | CN 12429A JL 17 JUL 73 |
| 2 | CN 23168 E JEP 30 MAR 82 |
| 3 | CN 32297 A LNM 15 JUN 90 |

M39012/23-0001

MASTER
S-D

KC-79-110

REF:
SUPERSEDES 116-1028A

| FINISH | SPEC. |
|--------|-------|
| | |
| MATL. | SPEC. |
| | |

BNC RECEPTACLE

DRAWN CC DATE 19 OCT 71
APPR JC DATE 12-8-71

KINGS ELECTRONICS
40 HARBLEDALE ROAD
TUCKAHOE, N. Y. 10707

DRAWING NO. M39012/23-0001

| QTY | REQ'D | DESCRIPTION | DRAWING NO. |
|-----|-------|---------------------|---------------|
| 9 | 1 | HEX NUT | 706-4-MC7 |
| 8 | 1 | LOCKWASHER | C-7L-03-7-MC1 |
| 7 | 1 | GASKET | 706-3-M99 |
| 6 | 1 | BNC ANGLE CONTACT I | |
| 5 | 1 | INSULATOR | |
| 4 | 1 | INSULATOR | |
| 3 | 1 | BODY ASS'Y | |
| 2 | 1 | RETAINING RING | |
| 1 | 1 | CONTACT | |

UNLESS OTHERWISE SPECIFIED:

1. TOLERANCES: FRACTIONS & 2 PLACE DECIMALS ± .010
3 PLACE DECIMALS ± .004
T. I. R. CONCENTRICITY OF ANY 2 DIAMETERS MAY NOT EXCEED HALF THE SUM OF THEIR TOLERANCES.
2. REMOVE ALL BURRS, BREAK SHARP EDGES .005 MAX.
3. NO FILLETS PERMITTED.
4. SURFACE ROUGHNESS 63 MICROINCHES RMS MAX.
5. ALL DIMENSIONS PRIOR TO PLATING.